

harmony®

DEFENDER 360° 3-IN-1 DELUXE CAR SEAT INSTRUCTION MANUAL

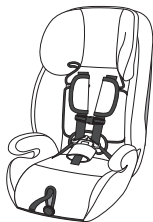

This child restraint is designed for use by children who meet the following requirements:

WITH HARNESS:

Weight: 26.5 - 65 lbs. (12 - 29.5 kg)

Height: 27 - 57 in (68.6 - 144.8 cm)

WITHOUT HARNESS:

Weight: 40 - 120 lbs. (18.4 - 54 kg)

Height: 34 - 57 in (86.4 - 144.8 cm)

READ THIS MANUAL

Do not install or use this child restraint until you read and understand the instructions in this manual.

FAILURE TO PROPERLY USE THIS CHILD RESTRAINT INCREASES THE RISK OF SERIOUS INJURY OR DEATH IN A SHARP TURN, SUDDEN STOP OR CRASH. KEEP INSTRUCTIONS FOR FUTURE USE.



IF ANY PARTS ARE MISSING, DO NOT RETURN THIS PRODUCT TO THE PLACE OF PURCHASE. PLEASE CONTACT HARMONY JUVENILE PRODUCTS CUSTOMER SERVICE AT 1-877-306-1001.

WELCOME TO THE HARMONY FAMILY!

Thank you for choosing the **Harmony® Defender 360° 3-in-1 Deluxe Car Seat**. You have chosen one of the safest and most comfortable options available for your child on the market.

At Harmony, we pride ourselves on bringing the most innovative, feature-rich products to our valued customers. We have designed this child restraint to be safe, comfortable and easy to use so that you can have peace of mind knowing your family is well protected.

Although it is not possible to predict if the use of a child restraint will prevent injury or death in the event of a collision, extensive testing has shown that this child restraint, when used properly, can reduce the risk of a child's injury or death in most accidents.

Please take the time to read and understand all the instructions and warnings for this child restraint. The safety of your child depends on the proper installation and use of this child restraint.

**REMEMBER TO ALWAYS BUCKLE UP
AND DRIVE SAFELY!**

Harmony Juvenile Products

Website: **www.harmonyjuvenile.com**

Mailing Address: **2435 Guenette Street
Montreal, Quebec
Canada H4R 2E9**

Telephone: **1-877-306-1001**

TABLE OF CONTENTS

Welcome to the Harmony family	1
Registration information	4
If you need help	5
Warnings	6
General warnings	6
Usage warnings	8
Injury warnings	9
Vehicle warnings	10
Certifications	10
Airbag warnings	11
Damage warnings	11
Choosing an appropriate vehicle seat location	12
Weight and Height limitations	14
With built-in harness	15
Without built-in harness (booster mode)	16
Maximum height	16
Parts list	17-19
Assembling/Disassembling child restraint	20
Installing child restraint in harness mode:	
LATCH or vehicle seat belt	21
Safe vehicle seat belt systems	22
Unsafe vehicle seat belt systems	22
Installing locking clip	23
Using Top Tether	25
Preparing child restraint for use	26
Adjusting harness shoulder straps	26
Adjusting crotch strap position	27
Recline	28
LATCH (Lower Anchors and Tethers for Children)	29
Installing with LATCH system	30
Installing with Lap-and-Shoulder or Lap-Only belt system	31

TABLE OF CONTENTS

Installation safety check	33
Using child restraint with built-in harness	33
Securing child in child restraint	34
Removing child from child restraint	36
Using child restraint in booster mode (without internal harness)	36
Removing/Installing harness	36
Booster with backrest	37
Entanglement with vehicle belt	40
Securing child and booster seat in vehicle	40
Booster without backrest	41
Installing shoulder belt safety guide	42
Using shoulder belt safety guide	43
Removing shoulder belt safety guide	43
Removing/Installing fabric seat cover	44
Installing cup holder (when applicable)	45
Care and maintenance	45
Aircraft installation	46
Instruction manual storage	46
Warranty	47

REGISTRATION INFORMATION

REGISTER YOUR CHILD RESTRAINT TODAY! Child restraints could be recalled for safety reasons. You must register this restraint to be reached in a recall. Send your name, address, email address if available and the restraint's model number and manufacturing date to:

**Harmony Juvenile Products
P.O. Box 3375
Champlain, NY, 12919-9800, USA**

or call **1-877-306-1001**

or register online at

http://www.harmonyjuvenile.com/us_en/register

For recall information,
call the **U.S. Government's Vehicle Safety Hotline at:**
1-888-327-4236 (TTY: 1-800-424-9153),
or go to *www.NHTSA.gov*

The model number, serial number and manufacturing date can be found on a label on the underside of the child restraint.

For recall information, any questions you may have, or to make a change of address or contact information, please call Customer Service at 1-877-306-1001 or visit us online at **www.harmonyjuvenile.com**.

**PLEASE DO NOT SEND IN YOUR
REGISTRATION CARD IF YOU HAVE
REGISTERED YOUR RESTRAINT ONLINE.**

IF YOU NEED HELP

Please fill in the information below for future reference. The model number and manufacturing date can be found on a label on the underside of your child restraint base.

Model Number: _____

Manufacture Date: _____

Date of Purchase: _____

Our Customer Service Department is standing by to help you with any questions or concerns you may have regarding installation, use, care, parts and/or maintenance. Please have your product's model number and manufacturing date available when contacting us. These numbers can be found on a label on the underside of your child restraint. You can reach us at www.harmonyjuvenile.com or 1-877-306-1001.

WARNINGS

GENERAL WARNINGS



WARNING!

The safety of your child and the effectiveness of this child restraint depend on:

1. **Selecting a suitable location** for the child restraint in your vehicle.
2. **Properly routing the LATCH or vehicle seat belt.**
3. **Properly securing both your child and the child restraint in the vehicle** using the harness system, or a seat belt designed to restrain both the child restraint and your child. Many seat belts are **NOT** safe to use with this child restraint. Please review the section “Unsafe vehicle seat belt systems” carefully. If in doubt about installing this child restraint, consult the vehicle owner’s manual or call the Harmony Customer Service Department.



WARNING!

FAILURE TO PROPERLY READ, FOLLOW AND USE THESE INSTRUCTIONS AND THE CHILD RESTRAINT LABELS INCREASES THE RISK OF SERIOUS INJURY OR DEATH IN A SHARP TURN, SUDDEN STOP OR CRASH. Your child’s safety depends on the proper installation and use of this child restraint. Even if this child restraint seems easy to install and use on your own, it is **VERY IMPORTANT** to read and understand these instructions and the vehicle owner’s manual.

Follow all labels on this child restraint and in these written instructions. **DO NOT INSTALL OR USE THIS CHILD RESTRAINT UNTIL YOU READ AND UNDERSTAND THE INSTRUCTIONS IN THIS MANUAL AND IN YOUR VEHICLE OWNER'S MANUAL.**

NO CHILD RESTRAINT CAN GUARANTEE PROTECTION WHEN THE VEHICLE IS SERIOUSLY IMPACTED. However, when correctly installed, a child restraint will substantially improve the chances for survival and reduce the risk of serious injury in most crashes.

Carefully follow the instructions in this manual and in your vehicle owner's manual. If there is a discrepancy between the two, the vehicle owner's manual must take precedence with regards to LATCH, seat belts, Top tethers and/or airbags.

- ! USE THIS CHILD RESTRAINT FORWARD FACING ONLY.**
- ! DO NOT USE THIS CHILD RESTRAINT** without properly assembling it.
- ! DO NOT** allow children to play with this child restraint.
- ! NEVER** leave children alone in a vehicle under any circumstance.
- ! Set a good example by ALWAYS** wearing your seat belt. Make it a firm rule that the vehicle does not move until everyone is buckled up. **MAKE NO EXCEPTIONS.**
- ! Harmony Juvenile Products** advises against loaning or passing along a child restraint. **DO NOT USE A SECOND-HAND CHILD RESTRAINT** or a child restraint whose history you do not know.

! To prevent injury due to deterioration, hidden damage, etc., discontinue use of this child restraint if it is older than **TEN (10) YEARS**. There is an expiry date for use of this child restraint indicated on the underside of the child restraint base. **STOP USING THE CHILD RESTRAINT AND THROW IT AWAY** after the date indicated. Please dispose of the unit in a way others cannot reuse it (e.g. use a dark trash bag, do not sell to a thrift shop or in a garage sale, etc.).

USAGE WARNINGS

The National Highway Traffic Safety Administration (NHTSA) and the U.S. Department of Transportation recommends that children under the age of 13 years be placed in the back seat of the vehicle and away from active front airbags.

According to accident statistics, **CHILDREN ARE SAFER WHEN PROPERLY RESTRAINED IN REAR VEHICLE SEATING POSITIONS THAN IN THE FRONT SEATING POSITION.**

Please study the section “Choosing an appropriate vehicle seat location”.

Many local police and fire departments frequently hold safety inspection events to ensure that child restraints are properly installed. Please contact your local emergency services department to see if and when they offer this service.

! Harmony Juvenile Products recommends **ALWAYS USING THE TOP TETHER WHEN USING THIS CHILD RESTRAINT WITH HARNESS**. Failure to use the vehicle seat belt **AND** Top tether, or LATCH **AND** Top tether, or to adjust it properly can result in your child striking the vehicle’s interior in a sharp turn, sudden stop or crash, which may result in serious injury or death.

- ! **DO NOT** allow others to install or use this child restraint unless they read and understand all the instructions and labels.
- ! **DO NOT GIVE THIS CHILD RESTRAINT** to someone else without also giving them this instruction manual.
- ! To ensure proper child restraint use, keep and store this instruction manual and refer to it when necessary.
- ! **DO NOT LEAVE A CHILD RESTRAINT UNSECURED IN YOUR VEHICLE.** In a collision, sharp turn or sudden stop, an unsecured child restraint can injure other occupants. Remove it or make sure that it is securely attached with the vehicle seat belt **AND** Top tether, or LATCH **AND** Top tether, even when not in use. If not using LATCH and/or Top tether, make sure LATCH and Top tether connectors are properly stored on back of the child restraint **1**.

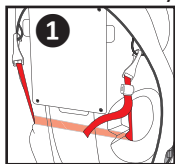

INJURY WARNINGS

- ! **INJURIES MAY OCCUR EVEN IF YOU ARE NOT IN A CRASH** if the child restraint is not properly installed or if your child is not properly secured in the child restraint.
- ! **DO NOT** leave folding vehicle seats unlatched. In the event of a sharp turn, sudden stop or crash, a loose seat back could prevent the child restraint from protecting the child as well as it should.
- ! **DO NOT** leave loose objects, e.g. books, bags, etc., in the back of a vehicle. In the event of a sharp turn, sudden stop or crash, loose objects will keep moving, potentially causing serious injuries.
- ! Store the child restraint in a safe place when not in

use. **DO NOT** place heavy objects on top of the child restraint while in storage.

- ! PARTS OF THE CHILD RESTRAINT COULD BECOME HOT ENOUGH TO BURN THE CHILD IF LEFT IN THE SUN.** Contact with these parts can injure your child. **ALWAYS** touch the surface of any metal or plastic parts before putting your child in the child restraint. Cover the child restraint with a towel or blanket when the vehicle is parked in direct sunlight.

VEHICLE WARNINGS

- ! DO NOT** use this child restraint with unsafe vehicle seat belts listed in section “Unsafe vehicle seat belt systems” of this manual. Your child would be seriously injured in the event of a crash.
- ! DO NOT** use this child restraint if it can’t be properly installed. It is possible that your vehicle has no suitable seating position for this child restraint due to seat belt type, airbag system and/or lack of location of a tether strap anchor. Read and follow these instructions, and your vehicle owner’s manual carefully.
- ! NEVER** attach two LATCH lower connectors to the same anchor point.

CERTIFICATIONS

This child restraint system conforms to *Federal Motor Vehicle Safety Standards*, section 213 and 213.2.

WHEN USED WITH HARNESS SYSTEM: This child restraint conforms to *Federal Motor Vehicle Safety Standards* 213 and is certified for use in passenger motor vehicles and aircraft.

WHEN USED WITHOUT HARNESS SYSTEM: This child restraint (booster seat) conforms to *Federal Motor*

Vehicle Safety Standard 213.2 and is certified for use in passenger motor vehicles only. This restraint is **NOT CERTIFIED** for aircraft use when used as a booster **WITHOUT** the harness.

This child restraint must **NOT** be used in homes, boats, buses, motorcycles, motor homes, or any other vehicles that have non-forward-facing seats, missing seat belts, or whose seat belts do not meet the requirements of this child restraint.

This child restraint is compatible with vehicle child restraint **Lower Anchors and Tethers for Children (LATCH)**.

AIRBAG WARNINGS

! NEVER PLACE THIS CHILD RESTRAINT IN A VEHICLE SEATING LOCATION THAT HAS AN ACTIVE AIRBAG. An inflating airbag may cause serious injury or death. Refer to your vehicle owner's manual for information about airbags and child restraint installation.

This child restraint may be used in a rear seating position equipped with side impact airbags providing they are:

- Roof mounted;
- "Curtain" type deployment;
- Will **NOT** interfere with, impact or in any way reposition the child restraint when inflated.

Please refer to your vehicle owner's manual for airbag type, and for appropriate use with child restraints.

DAMAGE WARNINGS

! DO NOT USE A CHILD RESTRAINT THAT HAS BEEN IN AN ACCIDENT OF ANY KIND. An accident can cause damage to the child restraint that you cannot see.

- ! **DO NOT** use this child restraint if it is damaged in any way or has missing parts.
- ! **DO NOT** tamper with or modify the child restraint, including the buckles, harness system or LATCH, for any reason.
- ! **NEVER** use a cut, frayed or damaged vehicle seat belt, LATCH belt or harness.
- ! **DO NOT** use anything to raise the child restraint off the vehicle seat. Untested modifications such as adding extra padding could affect the safety of the child restraint and result in serious injury or death in a crash.
- ! **DO NOT, EXCEPT AS DESCRIBED IN THESE INSTRUCTIONS, MODIFY YOUR CHILD RESTRAINT, DISASSEMBLE ANY PART OR CHANGE THE WAY THE HARNESS OR VEHICLE SEAT BELTS ARE USED.** This includes any accessories or parts by other manufacturers as non-tested accessories can affect the safety of the child restraint.

CHOOSING AN APPROPRIATE VEHICLE SEAT LOCATION



WARNING!

FAILURE TO PROPERLY SECURE YOUR CHILD AND THE CHILD RESTRAINT IN YOUR VEHICLE INCREASES THE RISK OF SERIOUS INJURY OR DEATH IN THE EVENT OF A SHARP TURN, SUDDEN STOP OR CRASH.

WARNING!

IMPROPER PLACEMENT OF THE CHILD RESTRAINT INCREASES THE RISK OF SERIOUS INJURY OR DEATH.

Some seating positions in your vehicle may **NOT** be safe for this child restraint. Some vehicles have **NO** seating positions which are compatible with this child restraint because of the type of seat, seat belt system, airbag system, lack of location to anchor the Top tether strap and/or any seating positions where the child restraint is level and stable when installed. **ALWAYS** read and follow the vehicle owner's manual for child restraint system use.

WARNING!

Children aged 13 and under **MUST** ride in the rear seats, away from front airbags. The only exception is if the airbags are turned off. When using a child restraint in a vehicle with airbags, refer to the vehicle owner's manual for additional installation instructions and precautions. Failure to disable the airbag system can result in serious injury or death.



WARNING!

Only use this child restraint in forward-facing vehicle seats. Side-facing or rear-facing seats in vans, station wagons or trucks **CANNOT** be used.

THE VEHICLE SEAT MUST FACE FORWARD. DO NOT use the child restraint with the following vehicle seats:

- Seats which face sides of vehicle.
- Seats which face rear of vehicle.
- Rear seats of small extended cab pickup trucks.



- The front of the child restraint **MUST NOT** hang over the edge of the vehicle seat by more than 2 inches (5 cm).

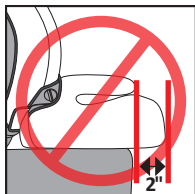

Refer to the vehicle owner's manual for child restraint installation instructions for your specific vehicle.

! DO NOT use this booster seat if it can't be properly leveled, stabilized, and installed as per this instruction manual. It is possible that your vehicle has no suitable seating position for this booster seat due to seating surface, seat belt type and/or airbag system. Read and follow these instructions, and your vehicle owner's manual carefully.

WEIGHT AND HEIGHT LIMITATIONS



WARNING!

THIS CHILD RESTRAINT HAS DIFFERENCES IN INSTALLATION AND USAGE DEPENDING ON THE WEIGHT AND HEIGHT OF YOUR CHILD. FAILURE TO USE THIS CHILD RESTRAINT WITHIN THESE GUIDELINES MAY INCREASE THE RISK OF SERIOUS INJURY OR DEATH.

! WARNING: Verify your child's height and weight frequently. **DO NOT** guess before choosing the proper setup for your child.

FOR MAXIMUM SAFETY:

If child is between 26.5 and 65 lbs. (12 - 29.5 kg) and shoulders are below the upper harness slots, Harmony Juvenile Products recommend use of the built-in harness or booster with backrest for as long as possible.

Harmony Juvenile Products recommends that you **ALWAYS** confirm state laws with local authorities. Laws vary from state to state regarding minimum / maximum child restraint requirements for age, weight and height.

WITH BUILT-IN HARNESS

Your child must meet **ALL** requirements:

- **Weight:** Between 26.5 and 65 pounds (12 - 29.5 kg).
- **Height:** Between 27 and 57 inches (68.6 - 144.8 cm).
- At least one (1) year old.
- Shoulders are **BELOW** top harness slots.
- Child's ears **MUST BE BELOW** top of the headrest. If tops of ears are above the top of the headrest at its maximum height, the child is too large for the child restraint.



WITHOUT BUILT-IN HARNESS (BOOSTER MODE)

Your child must meet **ALL** requirements:

- **Weight:** Between 40 and 120 pounds (18.4 - 54 kg).
- **Height:** Between 34 and 57 inches (86.4 - 144.8 cm).
- The shoulder belt **MUST** lie across child's shoulder and the lap portion of the belt **MUST** be positioned low on the child's hips.
- Child's ears **MUST BE BELOW** the top of the booster seat (with backrest) ① or the top of the vehicle seat back/vehicle headrest (without backrest) ②. If tops of ears are above the top of the booster seat or vehicle seat back/vehicle headrest, child is too large for the booster seat.

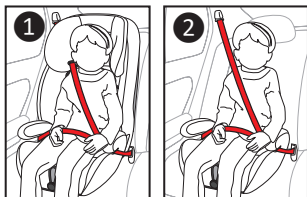

MAXIMUM HEIGHT

WARNING!

With Back Support: Child is too tall when top of ears (mid-point of child's head) are above the top of the child restraint's headrest.

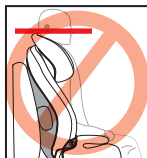

Without Back Support: Child is too tall when top of ears (mid-point of child's head) are above the top of the vehicle seat back or vehicle headrest.

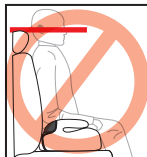

PARTS LIST

- A** - Headrest Fabric Cover (*Pre-Installed*)
- B** - Backrest Fabric Cover (*Pre-Installed*)
- C** - Seat Fabric Cover (*Pre-Installed*)
- D** - Shoulder Belt Guides
- E** - Harness Straps, Buckle and Clips
- F** - Chest Clip
- G** - Shoulder Pads
- H** - Crotch Strap and Pad
- I** - 1-Hand Headrest Height Adjustment Handle
(Under Headrest Fabric)
- J** - Cup Holder
- K** - Metal Up-Front Harness Adjustment Button
(Above Strap)
- L** - Up-Front Harness Adjustment Strap
- M** - Recline Knob
- N** - Top Tether
- O** - LATCH System
- P** - Harness Splitter Plate
- Q** - Mesh Storage Pouch
- R** - Backrest Plate
- S** - LATCH Storage Loops
- T** - Screw with Plastic Knob, Washers and Plastic
Encased Inner Bolt (x2)
- U** - Locking Clip
- V** - Shoulder Belt Safety Guide with 0.5 inch
(1.3 cm) Screw (for Backless Booster mode)
- W** - 8.8 inch (22.3 cm) Backrest Connector Rod
(Pre-Installed in base of backrest)
- X** - 0.5 inch (1.3 cm) Connector Rod Screw and
Washer
- Y** - Base Plate with Instruction Manual Storage
- Z** - Infant Insert Pad (when applicable)

TO PURCHASE REPLACEMENT PARTS:

In the United States or Canada, please
contact us at www.harmonyjuvenile.com
or by calling 1-877-306-1001.

PARTS LIST

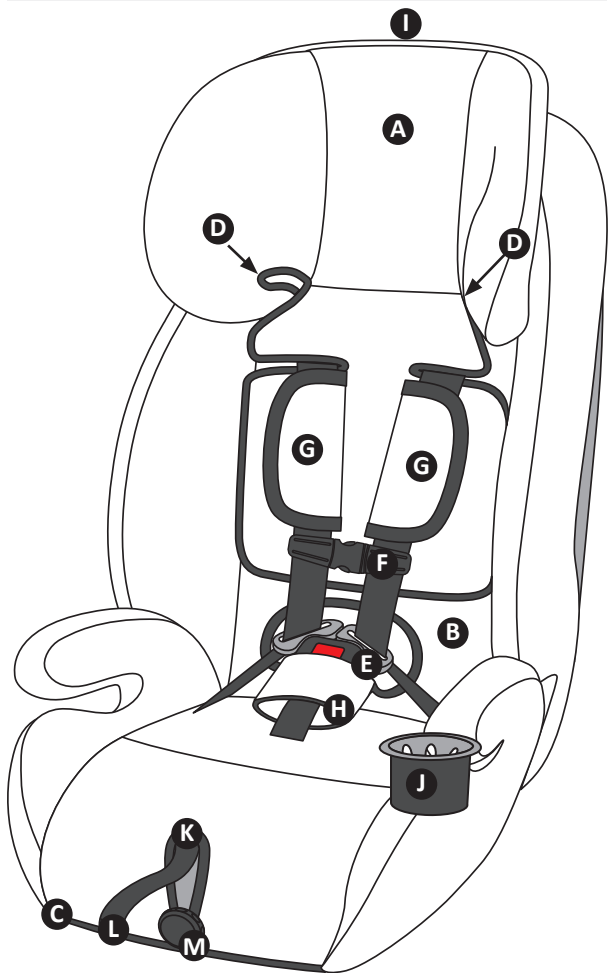

PARTS LIST

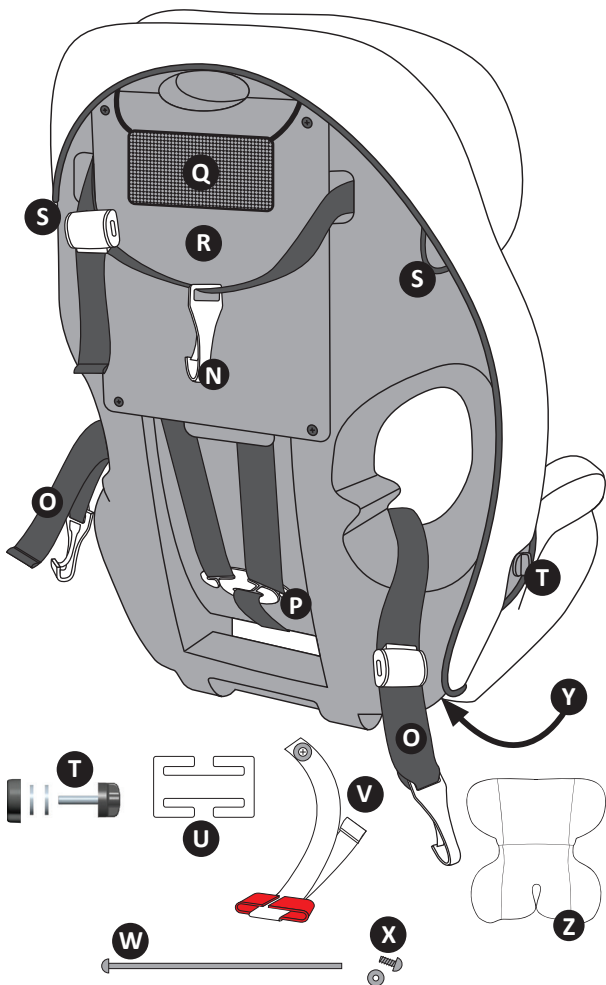

ASSEMBLING/DISASSEMBLING CHILD RESTRAINT

Adult assembly: 2 x Phillips Screwdrivers required.

1. Locate both sets of screws with plastic knob, washers and plastic encased inner bolts (Part T) in the hardware bag and set aside.
2. Locate the 0.5 inch (1.3 cm) screw and washer (Part X) in the hardware bag and set aside.
3. Identify the 8.8 inch (22.3 cm) backrest connector rod (Part W) pre-installed in base of backrest. Remove and set aside.
4. Place the backrest and base face down and slide the base plate between the two backrest anchor points. Pass the

8.8 inch (22.3 cm) connector rod through assembly. Insert the washer and 0.5 inch (1.3 cm) screw on opposite side and tighten ①.

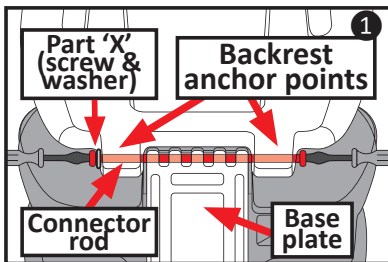

TIP: If connector rod does not pass through easily, make sure it is aligned with holes and tap screw head lightly to guide it through the plastic.

5. Turn assembly face-up and pull the backrest up into the vertical position. Pull up-front adjuster tight to hold the backrest in place.

Connect the backrest to the base in the upright position, ensuring that the backrest inserts snugly around the outside of the armrest grooves. Insert screw, washers (x2) and inner bolt as indicated in each armrest ②.

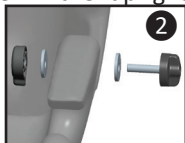

Ensure that the bolt is properly aligned with the indentation **3**. Secure assembly by turning screw clockwise until tight **4**.



TIP: Stretch backrest extensions out slightly to help guide them around the armrest grooves.

TIP: If screws do not pass through easily, make sure that the screw holes are aligned and tap screw head lightly to guide it through the armrest plastic.

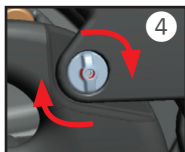

! WARNING: Ensure that all **THREE** connection points are secure and tight. **DO NOT** over tighten. **CHECK FREQUENTLY.**

INSTALLING CHILD RESTRAINT IN HARNESS MODE: LATCH OR VEHICLE SEAT BELT

You can install the child restraint using **EITHER** the LATCH or vehicle seat belt.

LATCH: The Lower Anchors and Tethers for Children (LATCH) is used for installing the child restraint **WITHOUT** using the vehicle seat belts.

! The LATCH can **ONLY** be used if your vehicle has the LATCH anchors installed and designated LATCH seating positions. Check your vehicle owner's manual to see which seating positions may be equipped with LATCH.

Vehicle Seat Belts: If LATCH is not an option, you **MUST** use the vehicle's lap-only or lap-and-shoulder belt to install the child restraint in your vehicle.

SAFE VEHICLE SEAT BELT SYSTEMS

WARNING!

SEAT BELTS DIFFER FROM VEHICLE TO VEHICLE AND FROM SEATING LOCATION TO SEATING LOCATION WITHIN THE SAME VEHICLE. NOT ALL VEHICLE SEAT BELTS CAN BE USED WITH THIS CHILD RESTRAINT. If you are unsure, consult your vehicle owner's manual or call Harmony Juvenile Products.

Review your vehicle owner's manual for vehicle seat belt use with child restraint systems.

NOT ALL VEHICLE SEAT BELTS WILL WORK WITH THIS CHILD RESTRAINT. You must determine if your vehicle's seat belts are compatible for use with this child restraint.

UNSAFE VEHICLE SEAT BELT SYSTEMS

This child restraint can be installed properly using **MOST** vehicle 3-point lap-and-shoulder seat belts. However, some vehicle seat belts are not safe to use as their anchoring points may not allow for a secure installation. **NEVER** use any unsafe vehicle seat belt systems.

DO NOT use any of the following vehicle seat belt systems with this child restraint:

- ! NEVER** use a lap-only belt.
- ! NEVER** use a seat belt that does not lock in the event of a sharp turn, sudden stop, or crash.
- ! NEVER** use a cut, frayed or damaged vehicle seat belt.
- ! NEVER** use motor driven automatic seat belts.

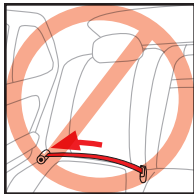

- ! **NEVER** use a vehicle seat belt system where the lap and shoulder belts have independent retractors.
- ! **NEVER** use a vehicle seat belt system with top or bottom anchorage points attached to the door in any way.
- ! **NEVER** use lap belts whose anchor points are forward of the seat crease.

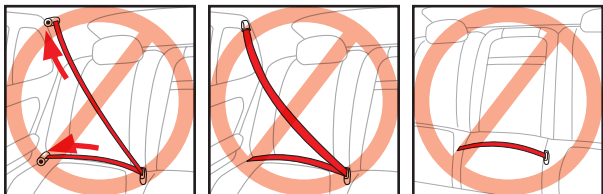

INSTALLING LOCKING CLIP

A locking clip is used to prevent certain vehicle seat belts from loosening before a sudden stop or crash. The locking clip can **ONLY** be used on a vehicle lap-and-shoulder belt. A locking clip will not fix all types of vehicle seat belt problems.



If your vehicle's 3-point lap-and-shoulder seat belt is equipped with an Emergency Locking Retractor (ELR) that is **NOT** convertible to function as an Automatic Locking Retractor (ALR), then the locking clip **MUST** be used.

If you have any questions about the specific type of seat belt system in your vehicle and/or its operation, consult your vehicle owner's manual.

- Remove the locking clip from mesh storage pocket on restraint backrest (see "Parts list").
- Follow the steps to properly secure vehicle lap-and-

shoulder seat belt (see “Installing with Lap-and-Shoulder or Lap-Only belt system”).

- Once seat belt is attached and properly adjusted, grasp the two straps (lap and shoulder) together as close to the vehicle belt buckle plate as possible. Unbuckle the belt without allowing it to slip.
- Attach the locking clip around both lap and shoulder belts **1**.
- Position the locking clip about 1 inch (2.5 cm) from vehicle belt’s buckle plate.
- Rebuckle belt. Check that the lap belt does not move by pulling hard. If belt loosens or lengthens, repeat the procedure.

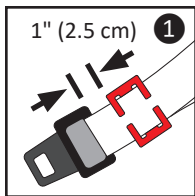

Test installation to see if child restraint is secure. The child restraint should **NOT** be able to move in any direction where it connects to the vehicle. If the child restraint can be moved more than 1 inch (2.5 cm) in any direction at the connection point, then unbuckle the seat completely and repeat the steps above until secure (see “Installation safety check”). If you have any questions, please contact Harmony Juvenile Products customer service.

! Store locking clip when not in use.

! **DO NOT** use locking clip in booster mode.

USING TOP TETHER

! THE TOP TETHER MUST BE USED AT ALL TIMES WHEN USING CHILD RESTRAINT IN HARNESS MODE. Using your child restraint with the Top tether strap properly anchored to the vehicle, as indicated in these instructions, may reduce the chance and severity of injury or death to your child in the event of a sudden stop or crash.

All LATCH seating positions have top tether anchors. Check your vehicle owner's manual for Top tether anchor locations. If your vehicle is not equipped with a top tether anchor, it may be possible to have one installed. Contact your vehicle dealership or a certified mechanic for the proper anchor location and installation.

Your vehicle's top tether Anchor Points may be identified using one of these symbols:

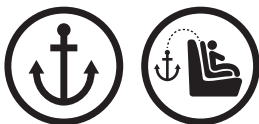

- Check that the top tether is securely attached to the child restraint.
- Fasten top tether clip to anchor point ensuring the clip is facing downwards and the strap is not twisted **1**.
- With the child restraint installed with the LATCH or vehicle seat belt, tighten the top tether strap securely by pulling on the free end of the top tether strap **2**.
- To loosen, press the top tether release button **3**.

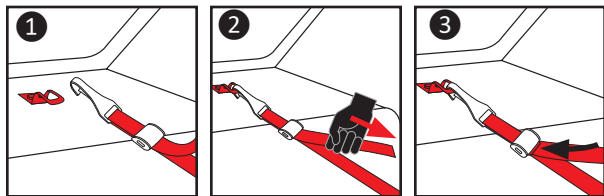

! WARNING: Ensure that tether strap is **NOT** twisted.

PREPARING CHILD RESTRAINT FOR USE

WARNING!

INCORRECT USE OF THE HARNESS SYSTEM IS THE MOST COMMON MISTAKE PEOPLE MAKE. IT IS VERY IMPORTANT TO READ, UNDERSTAND AND FOLLOW ALL INSTRUCTIONS AND WARNINGS. DO NOT MISTAKE COMFORT FOR SAFETY. THE HARNESS SYSTEM MUST BE SNUGLY ADJUSTED AT ALL TIMES.

! WARNING: The shoulder harness must be **EVEN OR SLIGHTLY ABOVE** the child's shoulders. If the upper most harness position is below the child's shoulders, **DO NOT** use this child restraint with harness.

! ENSURE the harness height is correct for your child's size. **VERIFY OFTEN.**

! WARNING: **DO NOT** use this child restraint if the midpoint of your child's head is above the top of the child restraint's headrest at its maximum height.

ADJUSTING HARNESS SHOULDER STRAPS

1. Loosen harness system by pushing the up-front metal harness adjuster at the front of the seat just above the adjustment strap **1** and simultaneously pulling the chest strap towards you **2**.

2. Have your child sit in the child restraint with their back flat against the backrest.

3. Reach into the opening on the top of the headrest fabric cover and find the **RED** one-hand headrest height adjustment button.

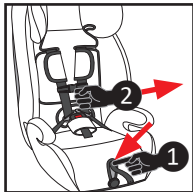

- Squeeze button and lift the headrest until the shoulder straps are at or just above your child's shoulders.
- Release the button and listen for a 'click' to make sure harness is locked in place.

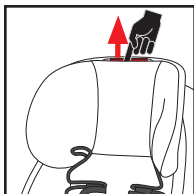

! WARNING: To ensure headrest is locked in position, gently push down on headrest.



WARNING!

FAILURE TO ADJUST THE HARNESS STRAPS CORRECTLY COULD RESULT IN SERIOUS INJURY OR DEATH.

ADJUSTING CROTCH STRAP POSITION

The crotch strap has two (2) positions.

- Remove fabric crotch pad.
- Push the buckle down through the fabric seat cover towards the plastic base of the child restraint.
- Lift the fabric seat cover on the base of the child restraint to expose the buckle and slot positions.
- Guide the crotch strap through the plastic base to the desired slot position ①.

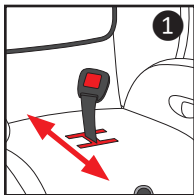

! ENSURE that the strap is **COMPLETELY** in the desired slot and the harness strap is **NOT** twisted.

! ENSURE that the buckle is facing **FORWARD** ②.

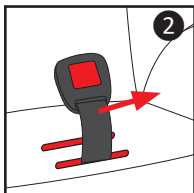

5. Push the buckle upwards through the fabric seat cover.
6. Replace fabric seat cover and fabric crotch pad.



WARNING!

FAILURE TO REINSTALL THE CROTCH STRAPS CORRECTLY COULD RESULT IN SERIOUS INJURY OR DEATH.

REMEMBER to check the shoulder straps and crotch strap position frequently and move them to the next position when necessary. The harness straps **MUST** be in the height position even with or just above the shoulders, and the crotch strap **MUST** be in the slot at or immediately in front of your child. The harness pads and crotch pads are optional and are not a safety feature.

TIP: For children over 40 lbs. requiring more harness length, remove black EPP pad under fabric on base of unit and infant insert (if applicable).

RECLINE



WARNING!

YOUR CHILD RESTRAINT RECLINES TO ENSURE PROPER INSTALLATION INTO YOUR VEHICLE. THE CHILD RESTRAINT MUST BE INSTALLED SO THAT ALL OF ITS SURFACE AREA IS IN CONTACT WITH YOUR VEHICLE SEAT.

Place the child restraint in the desired seating position (see “Choosing an appropriate vehicle seat location”), and turn the front recline adjust knob **1** to recline the backrest **UNTIL THE BACKREST LIES FLUSH ON THE VEHICLE SEAT BACK** **2**.

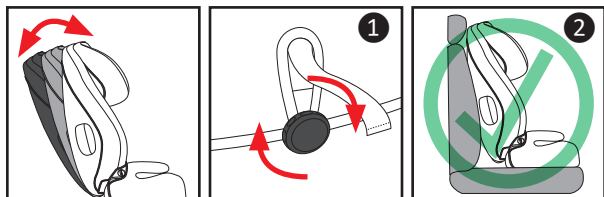

! WARNING: Remove the vehicle headrest and/or mesh storage pouch if it inhibits the child restraint from lying flush against the vehicle seat back **3**.



LATCH (LOWER ANCHORS AND TETHERS FOR CHILDREN)

If your vehicle is equipped with LATCH, the vehicle LATCH anchorage points may be visible at the seat crease. If not visible, they may be marked with this symbol.



Check your vehicle owner's manual for your vehicle's exact LATCH locations, anchor identifications and usage requirements for use with a child restraint.

! DO NOT install by this method for a child weighing more than 50 lbs. (22.68 kg).

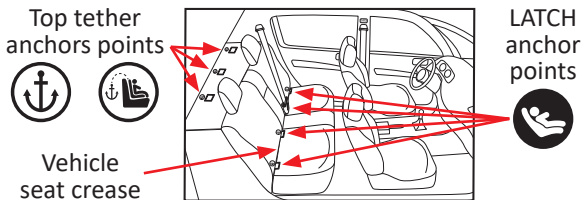

! WARNING: CONSULT YOUR VEHICLE OWNER'S MANUAL FOR THE EXACT PLACEMENT OF THESE ELEMENTS IN YOUR VEHICLE, AND FOR MAXIMUM LATCH WEIGHT ALLOWANCES PRIOR TO INSTALLATION AS SOME MANUFACTURERS HAVE LOWER MAXIMUM WEIGHT ALLOWANCES FOR LATCH USAGE.

INSTALLING WITH LATCH SYSTEM

1. Unhook LATCH from storage loops. For ease of installation, extend LATCH to its maximum length. Ensure the LATCH strap is **NOT** twisted and that the LATCH connectors are facing down ①.
2. Place the child restraint flush against a forward-facing vehicle seat, centered between the LATCH anchors. Adjust the recline as necessary (see "Recline").
3. Fasten LATCH hooks to vehicle lower anchors ensuring the hooks are facing downwards ②. Pull firmly to be sure that they are attached. **BELT MUST LAY FLAT AND NOT BE TWISTED.**
4. Tighten LATCH by placing your knee on the child restraint base and by using your full weight to push the child restraint down as you simultaneously pull upwards on the free end of the adjustment belt ③.

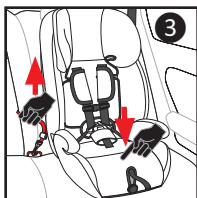
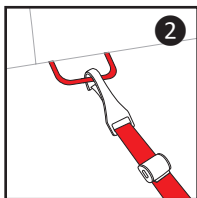
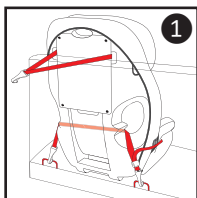

TIP: If you are not able to tighten LATCH using the method above, try pulling the LATCH strap up through the belt path (under the fabric) ④, then tighten.

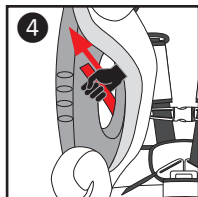

5. Should you need to loosen the LATCH, push the LATCH release button ⑤.

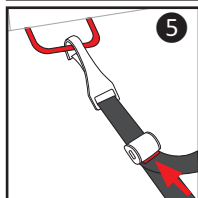

! WARNING: NEVER put two LATCH connectors on one vehicle LATCH anchor unless specifically allowed by the manufacturer ⑥.

6. Secure the top of the child restraint using the top tether strap (see “Using top tether”).



! Conduct a safety check for a secure installation (see “Installation safety check”). Perform this test every time you drive with your child and whenever you readjust the child restraint as your child grows.

INSTALLING WITH LAP-AND-SHOULDER OR LAP-ONLY BELT SYSTEM

! WARNING: LATCH must be stored when using the vehicle belt. Clip both LATCH hooks to the fabric loops on each side of the backrest ①.

1. Place the child restraint flush against the back of a forward-facing vehicle seat. Adjust the recline as necessary (see “Recline”).

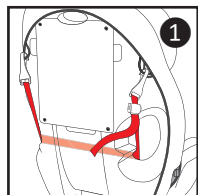

2. Thread the vehicle seat belt through the belt slot opening and out the other side. See illustrations for proper routing path of Lap-and-Shoulder Belt ② or Lap-Only Belt ③.

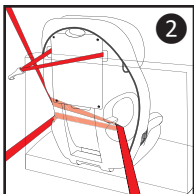

3. Buckle the vehicle seat belt. The vehicle seat belt **MUST NOT** be twisted.

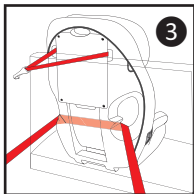

To engage vehicle seat belt retractor:

4. Pull out the full length of the seat belt (until you cannot pull out any more slack). This locks the retractor.

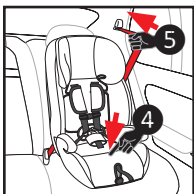

5. Tighten vehicle seat belt by placing your knee on the seat base and by using your full weight to push the child restraint down ④ as you simultaneously release the extra belt length until seat belt is taught and has no slack ⑤.

6. The locked seat belt retractor will not allow you to add any length to the belt until you unbuckle the seat belt.

For more information on how to tighten the belt for your seat belt system, see your vehicle owner's manual.

7. Secure the top of the child restraint using the top tether strap (see section "Using top tether").

INSTALLATION SAFETY CHECK

Perform this test **EVERY TIME** you drive with your child and whenever you readjust the child restraint as your child grows:

Rock the child restraint back and forth and side to side to make sure the LATCH or vehicle seat belt does not lengthen or loosen, and the child restraint does not move easily ①.

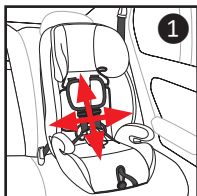

The back of the child restraint (connection point) should not move more than 1 inch (2.5 cm) in any direction.

If the child restraint is loose or not properly secured, repeat procedure OR find another location for the child restraint (see “Choosing an appropriate vehicle seat location”).

USING CHILD RESTRAINT WITH BUILT-IN HARNESS

WARNING!

FAILURE TO FASTEN AND TIGHTEN THE HARNESS SYSTEM CORRECTLY MAY CAUSE THE CHILD TO BE EJECTED FROM THE RESTRAINT SYSTEM IN CASE OF A SHARP TURN, SUDDEN STOP OR CRASH CAUSING SERIOUS INJURY OR DEATH. In a crash, the child restraint will provide **NO** protection for your child unless the harness straps are properly secured. **DO NOT** mistake comfort for safety. Harness system **MUST** be snugly adjusted. Follow these instructions carefully.

! Incorrect use of the harness system is the most common mistake people make. It is **VERY** important to read, understand and follow **ALL** instructions and warnings. **DO NOT** mistake comfort for safety. The harness system **MUST** be snugly adjusted at all times.

! Snugly adjust the harness provided with this child restraint around your child. A snug strap is one with no slack. It should not press on the child's flesh or cause your child's body to be in an unnatural position. You should only be able to slide **ONE FINGER** between the shoulder straps and the child's shoulder.

! Avoid unnecessary bulky clothing.

SECURING CHILD IN CHILD RESTRAINT

1. Open harness chest clip by pressing in pin clips while pulling apart the two-piece chest clip ①.

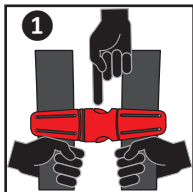

2. To loosen the harness strap: Push the up-front metal harness adjuster at the front of the seat just **ABOVE** the adjustment strap ② and simultaneously pull the chest strap towards you ③.

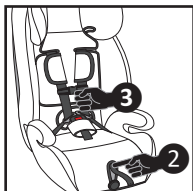

3. Unbuckle harness straps by pressing on the **RED** buckle release button and by pulling the buckle clips out ④. Move harness straps to the side.

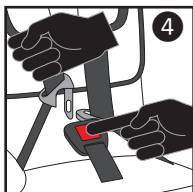

4. Place child in child restraint with child's back flat against back of the backrest.

5. Adjust headrest height so that the bottom of the headrest is even with the top of the child's shoulders.

6. Place harness straps over child's shoulders and insert buckle clips into buckle until they 'click' into place ⑤.

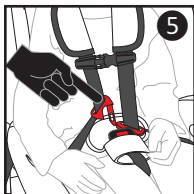

! ENSURE that harness clips and buckle are properly fastened by gently tugging on each.

! ENSURE that the straps are **NOT** twisted.

! **DO NOT** use child restraint if harness does not lock.

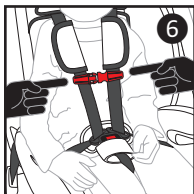

7. Re-fasten chest clip ⑥.

8. Tighten harness system by gently pulling on the up-front harness adjuster strap until all slack is removed from the system ⑦.

! ENSURE straps are flat and snug against child's shoulders and thighs. You should **NOT** be able to slide more than one finger between the strap and the child's shoulder ⑧.

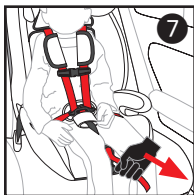

A snug strap should not allow any slack. It lies in a relatively straight line without sagging. It does not press on the child's flesh or push the child's body into an unnatural position.

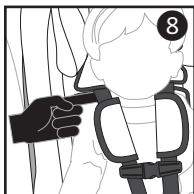

9. Position the chest clip at mid-chest, in line with your child's armpits and away from your child's neck.

REMOVING CHILD FROM CHILD RESTRAINT

1. Open harness chest clip by pressing in pin clips while pulling apart the two piece chest clip.
2. Loosen the harness system by pressing on the up-front metal harness adjuster, and simultaneously pulling the shoulder straps towards you.
3. Unbuckle harness by pressing on **RED** buckle release button.

USING CHILD RESTRAINT IN BOOSTER MODE (WITHOUT INTERNAL HARNESS)

REMOVING/INSTALLING HARNESS

! WARNING: The BASE seat cover can be removed without removing the harness.

1. Open chest clip and harness buckle.
2. Face the rear of the child restraint and remove the harness straps from the splitter plate **1**.
3. Pull shoulder straps out of their respective slots in the backrest **2**.

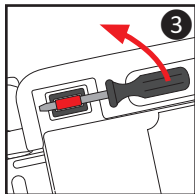
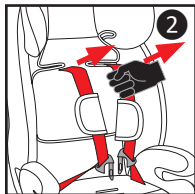
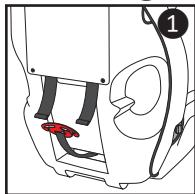

4. Lie child restraint on its side and find the metal locking plate for each harness strap on the underside of the base of the child restraint. Place a screwdriver under the loop of the strap and pry up to unlock the metal locking plate from the plastic base **3**. Turn each metal plate so that it can slide up and out through the plastic seat base.



5. Store complete harness system for future use.

6. Store crotch buckle under fabric seat cover in the indentation in the plastic seat base ④.

7. Pull the up-front harness adjustment strap as far as it will go. This will lock the splitter plate into the base of the seat ⑤.

8. Roll strap tightly, secure roll with an elastic band and store rolled strap under the fabric seat cover in the opening of the up-front adjuster.

To reinstall, remove Backrest Plate and reverse the above steps. When re-inserting the shoulder straps through the backrest, ensure the straps are **ABOVE** the metal bars inside the slots in the backrest ⑥. Reinstall Backrest Plate once harness is properly reinstalled.

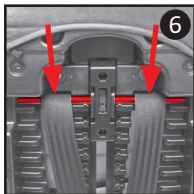
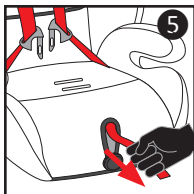

BOOSTER WITH BACKREST

WARNING!

! **ALWAYS** ASSIST YOUR CHILD WHEN GETTING INTO AND OUT OF YOUR CHILD RESTRAINT/BOOSTER SEAT.

! **NEVER** LET YOUR CHILD LEAN ON THE ARMREST WHEN GETTING INTO OR EXITING THE BOOSTER SEAT TO PREVENT THE SEAT FROM TIPPING.

! **ENSURE** THAT THE BOOSTER SEAT IS LEVEL, STABLE AND DOES NOT ROCK SIDE-TO-SIDE. IF THE BOOSTER SEAT IS NOT STABLE, TRY ANOTHER SEATING LOCATION. IN VEHICLES WITH WIDE, FLAT SEATS, A ROLLED TOWEL CAN BE USED ON THE OUTBOARD (DOOR) SIDE TO ADD STABILITY TO THE BOOSTER SEAT. **DO NOT ADD ANYTHING BEHIND OR UNDER THE BOOSTER SEAT.**



WARNING!

FAILURE TO PROPERLY SECURE YOUR CHILD IN THE BOOSTER SEAT INCREASES THE RISK OF SERIOUS INJURY OR DEATH IN THE EVENT OF A SHARP TURN, SUDDEN STOP OR CRASH. In a crash, the child restraint provides **NO** protection for your child unless the vehicle 3-point lap-and-shoulder belt is properly secured. Follow these instructions carefully to properly secure your child.

! DO NOT use this booster seat if it can't be properly leveled, stabilized, and installed as per this instruction manual. It is possible that your vehicle has no suitable seating position for this booster seat due to seating surface, seat belt type and/or airbag system. Read and follow these instructions, and your vehicle owner's manual carefully.

! DO NOT use infant insert in booster mode (when applicable).

! WARNING: Use **ONLY** the vehicle's lap and shoulder belt system when restraining the child in this booster seat. **LATCH WILL NOT** secure your child in the booster seat **1**.

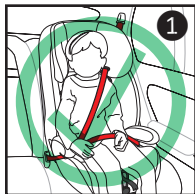

! WARNING: Vehicle belts **MUST NOT** be twisted and **MUST** lay flat against child's chest and lap.

! NEVER use a vehicle lap-only belt to secure child in child restraint **2**.

! NEVER USE A LOOSE SHOULDER BELT.

! NEVER position the shoulder belt under the child's arm **3** or place



the shoulder belt behind the child's back ④.



! Lap portion of lap-and-shoulder belt **MUST** be low and snug across the hips, just touching the child's thighs. The lap portion **MUST NOT** be lying across the child's stomach as this can cause major injuries to the child in case of a sharp turn, sudden stop or crash.



! **DO NOT** allow the child to slouch, slide down in the seat, or create slack in the belt system ⑤. If child will not keep vehicle belt properly positioned, **DO NOT** use this child restraint in booster seat mode. Use an alternate method or a different child restraint.

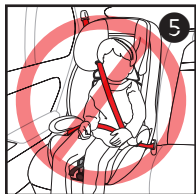

! **DO NOT** position vehicle belt over top of the armrests ⑥.



! The vehicle seat headrest should not create a gap between vehicle seat and booster seat ⑦. If so, remove the vehicle headrest.

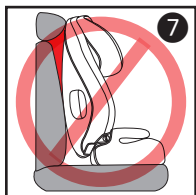

ENTANGLEMENT WITH VEHICLE BELT

! WARNING: To avoid possible entanglement and choking with your vehicle's shoulder belts, Harmony Juvenile Products recommends that the following precautions are taken when installing your booster seat:

1. Pull the shoulder portion of the vehicle seat belt all the way out until the retractor locks.
2. **SLOWLY** let the vehicle seat belt retract until it is snug against your child.
3. **ENSURE** that the belts do not press on the child's flesh or push the child's body into an unnatural position.
4. Do the same for all unused vehicle seat belts.

! Teach your child that vehicle seat belts are not toys and should **NEVER be played with, regardless of whether the car is in motion or not.**

! ALWAYS be aware of what your children are doing in the back seat.

SECURING CHILD AND BOOSTER SEAT IN VEHICLE

1. Place booster seat firmly against the back of a forward-facing vehicle seat. The vehicle seat **MUST** be equipped with a lap-and-shoulder belt. Booster must be level, stable and not rock side-to-side (see "Choosing an appropriate vehicle seat location").
2. Place child in the booster seat with child's back flat against the back of the booster seat.
3. Adjust headrest height so that the bottom of the headrest is even with the top of the child's shoulders.
4. Thread the shoulder belt portion of the 3-point lap-and-shoulder belt through the headrest shoulder belt guide **1** and ensure that the shoulder belt lies across child's shoulder and chest, and **NOT** across child's face or neck.

5. Thread both sides of the lap belt under BOTH armrests. Thread the lower end of the shoulder belt under the armrest on the buckle side ②. ENSURE that the belt is snug across the child's hips. It is important to ensure that any lap strap is worn low down, so that the pelvis is firmly engaged, just touching their thighs and is NOT across their stomach.
6. Buckle vehicle seat belt into place ③ and ensure it is secure by gently pulling on it.

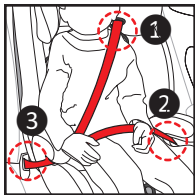

- ! THE LAP BELT PORTION MUST PASS UNDER BOTH ARMRESTS.**
- ! NEVER USE A VEHICLE LAP-ONLY BELT WHEN USING THIS CHILD RESTRAINT.**
- ! WARNING:** To avoid possible entanglement hazard, see “Entanglement with vehicle belt”.

WARNING!

DUE TO VARYING ANGLES OF VEHICLE SEAT BELT RETRACTORS, EXCESS SLACK IN THE VEHICLE BELT SYSTEM MIGHT NOT BE REMOVED AUTOMATICALLY. Once the lap and shoulder portions of the seat belt are properly positioned and the buckle is attached, **FEED ANY REMAINING SLACK OF THE SEAT BELT MANUALLY BACK INTO THE RETRACTOR TO TIGHTEN THE WHOLE SYSTEM.**

BOOSTER WITHOUT BACKREST

See “Assembling/Disassembling child restraint” for instructions for removing the backrest. Once backrest is removed, turn recline knob clockwise until end is reached to retract the base plate on the bottom of the seat.

1. Place the booster seat firmly against the back of a forward-facing vehicle seat in a position equipped with a vehicle lap-and-shoulder belt and headrest.

Booster must be level, stable and not rock side-to-side (see “Choosing an appropriate vehicle seat location”).

2. Have your child sit on the booster seat with their back flat against the vehicle seat.

3. Thread both sides of the lap belt under BOTH armrests. Thread the lower end of the shoulder belt under the armrest on the buckle side. ENSURE that the belt is snug across the child’s hips. It is important to ensure that any lap strap is worn low down, so that the pelvis is firmly engaged, just touching their thighs and is NOT across their stomach.

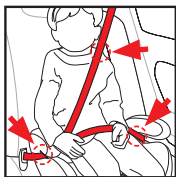

4. Buckle vehicle seat belt into place and ensure it is secure by gently pulling on it.

! THE LAP BELT PORTION MUST PASS UNDER BOTH ARMRESTS.

! NEVER USE A VEHICLE LAP-ONLY BELT WHEN USING THIS CHILD RESTRAINT.

! WARNING: To avoid possible entanglement hazard, see “Entanglement with vehicle belt”.

INSTALLING SHOULDER BELT SAFETY GUIDE

1. Locate the shoulder belt safety guide strap and screw in the storage pouch.

2. Using a Phillips screwdriver, attach belt safety guide strap to booster seat base by screwing into the pre-drilled hole in the back of the seat base.

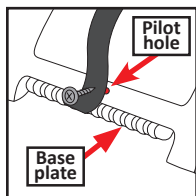

! Before tightening screw, make sure belt strap is pointing upwards and that the RED belt safety guide opening is facing forward. DO NOT overtighten screw.

USING SHOULDER BELT SAFETY GUIDE

1. Slide the vehicle's shoulder belt into the **RED** clip ensuring it is flat. Position the belt guide just above the child's shoulder ①.

! THE VEHICLE'S SHOULDER BELT MUST LIE ACROSS THE CHILD'S SHOULDER.

! OPENING OF RED BELT SAFETY GUIDE CLIP MUST FACE FORWARD.

! All straps MUST be tight and NOT twisted. ALL slack MUST be removed from lap and shoulder portions of the vehicle belt to ensure a snug fit. THE LAP BELT PORTION MUST PASS UNDER BOTH ARMRESTS AND BE POSITIONED LOW ON THE HIPS.

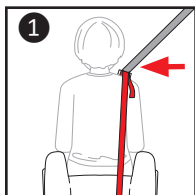

REMOVING SHOULDER BELT SAFETY GUIDE

1. Remove vehicle seat belt from **RED** belt safety guide clip.
2. Unscrew shoulder belt safety guide from the back of the base.

It is recommended to store the unused shoulder belt safety guide along with any other parts from the child restraint for future use.

REMOVING/INSTALLING FABRIC SEAT COVER

TO REMOVE

See “Removing/Installing harness”.

THE HARNESS DOES NOT NEED TO BE REMOVED IN ORDER TO REMOVE THE HEAD AND BASE FABRIC COVERS.

HEADREST:

1. Gently slide fabric downwards off the top of the headrest.
2. Unhook the elastic loops from each headrest shoulder belt guide opening on the bottom of the headrest.

BACKREST:

1. Undo the fabric hook-and-loop fastener tabs (x2) **1** along the bottom sides of the backrest (where the backrest meets the base).
2. Gently slide fabric cover off the backrest.
3. Remove EPE foam from backrest fabric.

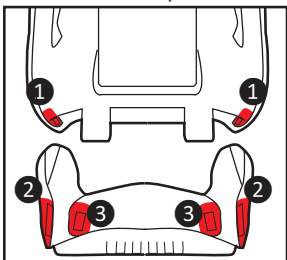

BASE:

1. Undo the fabric hook-and-loop fastener tabs (x4) **2** **3** as indicated.
2. Gently slide the fabric cover off the plastic base from the back of the child restraint towards the front of the seat. Make sure that recline knob does not get caught on fabric as you remove seat cover.

TO INSTALL

To reinstall fabric covers, repeat previous steps in reverse order.

TIP: For ease of fabric cover installations, turn recline knob counterclockwise to open gap at base of backrest to facilitate passing the hook and loop tabs through the gap to secure.

! CAUTION: Reinstall harness system if applicable (see “Removing/Installing harness”).

INSTALLING CUP HOLDER (WHEN APPLICABLE)

1. The cup holder can be installed on either side of the child restraint.
2. Locate the opening in the end of either armrest.
3. Insert cup holder clip into the opening and push in until locked into place. Ensure that the fabric does not interfere with the installation. If so, gently pull down on the fabric while installing cup holder.
4. Pull out to remove.

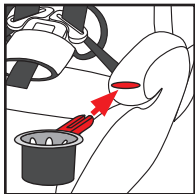

CARE AND MAINTENANCE

CLEANING YOUR SEAT COVER:

- **MACHINE WASH SEPARATELY** using cold water - delicate cycle.
- **DO NOT BLEACH.**
- **DRIP DRY** to prevent cover from shrinking.
- ! **DO NOT** wash EPE foam pad insert in backrest.

CLEANING THE PLASTIC SHELL:

- **SPONGE CLEAN** using warm water and mild soap.
- **TOWEL DRY.**
- **DO NOT** use solvents, abrasive cleaners, or disassemble child restraint in any way, except as instructed.

CLEANING HARNESS AND LATCH STRAPS:

- Spot clean with a damp cloth. **DO NOT BLEACH.** **DO NOT** immerse the straps in water. Doing so may weaken the straps.

CLEANING METAL AND PLASTIC HARNESS PARTS:

- Use mild soap and cool water on a damp cloth.

! NEVER lubricate the buckle. If buckle or harness adjuster sticks or will not remain tight, check for foreign objects such as food, dirt, etc. Remove objects with tweezers and/or clean with a cotton swab. If you cannot get the harness to remain tight with the buckle securely locked, **DO NOT USE** this child restraint. Call Harmony Juvenile Products to purchase a replacement harness or buckle.

AIRCRAFT INSTALLATION

This restraint is certified for use in aircraft **ONLY** when used **WITH** the harness.

This restraint is **NOT CERTIFIED** for aircraft use when used as a booster **WITHOUT** the harness. Aircraft seats are not equipped with 3-point lap-and-shoulder belts which are required for use with this child restraint.

IMPORTANT POINTS TO REMEMBER:

1. Contact your airline before using this child restraint on the aircraft in order to comply with their restrictions and regulations.
2. Install this child restraint on an aircraft in the same way it is installed in an automobile with a lap belt (see "Installing with Lap-and-Shoulder or Lap-Only Belt System").
3. Check that the aircraft seat belt holds the child restraint securely in place at all times. If it does not, **DO NOT** use this child restraint.

INSTRUCTION MANUAL STORAGE

Store your instruction manual in the storage section provided in the base plate on the bottom of your child restraint.

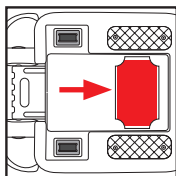

WARRANTY

This child restraint was manufactured by **Harmony® Juvenile Products** (HJP). HJP warrants this product to the original retail purchaser as follows:

LIMITED 1-YEAR WARRANTY

This child restraint is warranted against defective materials and workmanship for one year from the date of original purchase. *An original receipt is required to validate your warranty.* HJP will, at its option, provide replacement parts for this product or replace this product. HJP reserves the right to discontinue or change fabrics, parts, models or products, or to make substitutions.

To make a claim under this warranty, you must contact HJP Customer Service at **www.harmonyjuvenile.com**, or call 1-877-306-1001, or write to 2435 Guenette Street, Montreal, Quebec, Canada, H4R 2E9.

Proof of purchase is required and shipping charges are the responsibility of the consumer.

WARRANTY LIMITATIONS

This warranty does not include damages which arise from negligence, misuse, or use not in accordance with this instruction manual.

The use of non-Harmony branded covers, inserts, toys, accessories or tightening devices is not approved by HJP. Their use could cause this child restraint to fail federal safety standards or perform worse in a crash. Their use automatically voids the HJP warranty.

LIMITATIONS OF DAMAGES

The warranty and remedies as set forth above are exclusive and in lieu of all others, oral or written, expressed or implied. In no event will HJP or the retailer selling this product be liable to you for any damages, including incidental or consequential damages, or loss of use arising out of the use or inability to use this product.

PLEASE REGISTER THIS CHILD RESTRAINT WITHIN 30 DAYS OF PURCHASE TO EXPEDITE WARRANTY CLAIMS AND TO VERIFY ORIGINAL DATE OF PURCHASE.